

# caraway

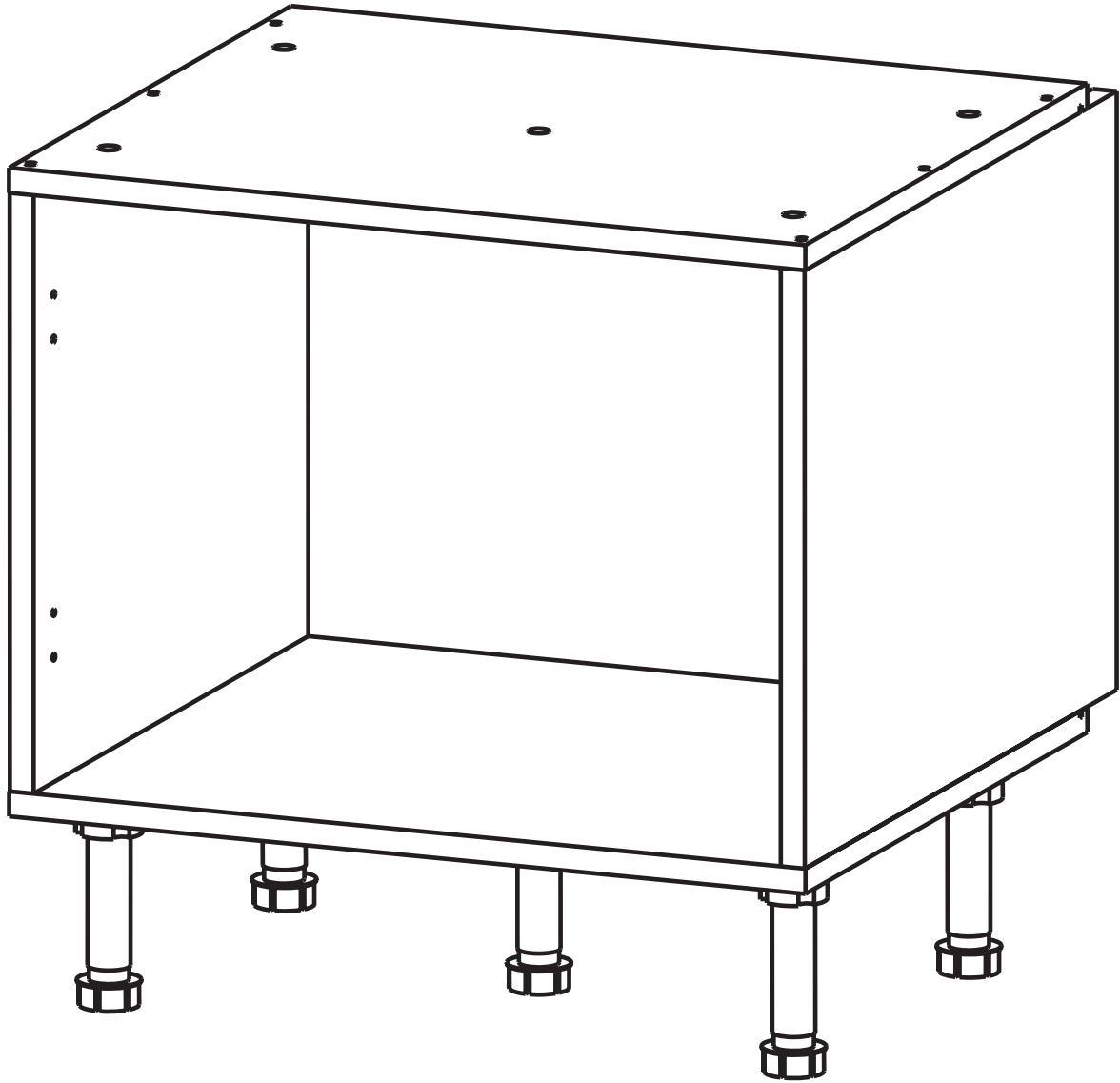

**3663602637547**

**60cm Wide Belfast Sink Base Cabinet**

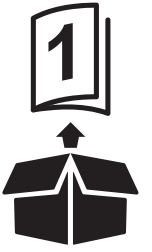

## Contents



**Before you start 04**



**Safety Instructions 04**



**Assembly 05**



**Care &  
Maintenance 10**



**Guarantee 10**



=



**WARNING!** Please read all safety warnings carefully and be sure that they are understood before handling the product

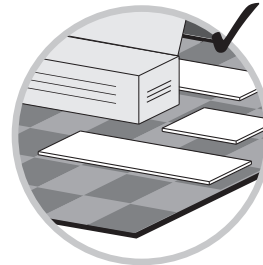
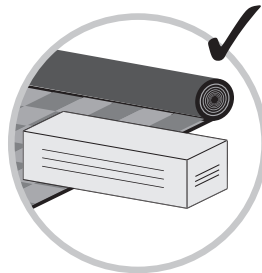
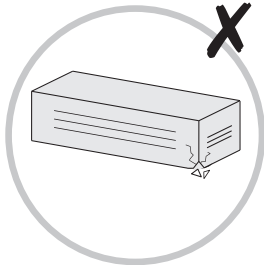
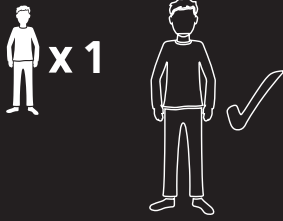

### Minimum tools required

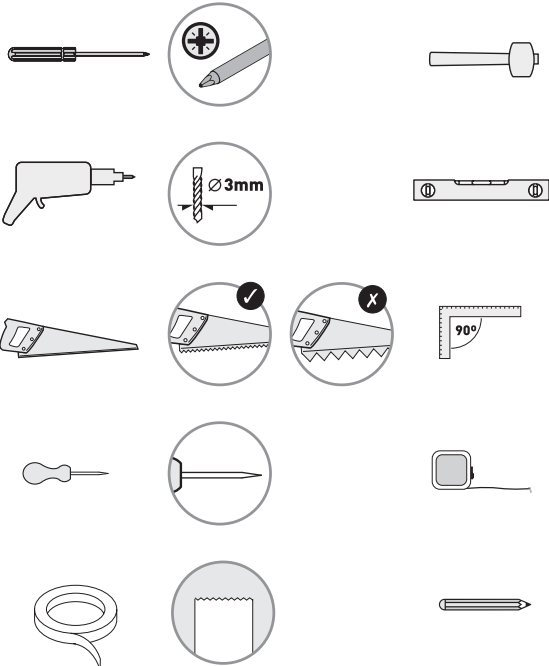

### Package includes

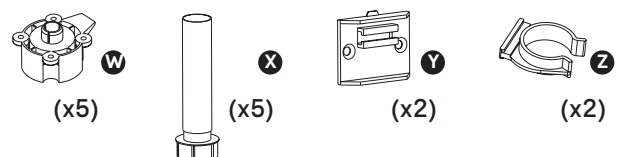
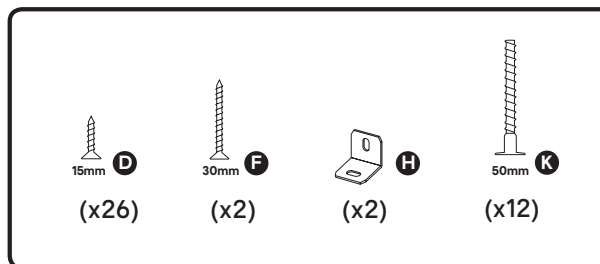



## Before you start

4

- Important information.
- Read carefully.
- Retain these instructions for future reference.
- If any parts are missing or damaged, contact Customer Services. Details for your retailer can be found in the 'Addresses' section of this manual.
- Make sure you have all of the parts listed. Check all of the packaging as components may be concealed; do not dispose of packaging until you have located all of the parts.
- When you are ready to start make sure you have the right tools to hand, plenty of space and a clean dry area for assembly.
- Failure to follow these instructions may result in personal injury, damage to the product and your property.
- **CAUTION:** Do not overtighten fixings as this may damage the product.
- For domestic use only.
- If you are in any doubt as to how to install this product, consult a technically competent person.



## Safety instructions

- **WARNING:** In order to prevent overturning this product must be used with the wall attachment device provided.
- **WARNING:** Installation must be performed by a competent person only. This product could be dangerous, cause injury or damage to property if incorrectly installed.
- Some parts could be hazardous to small children.
- Keep all parts out of reach and do not leave children unattended in the assembly area.
- Serious or fatal crushing injuries can occur from furniture tip-over.

To prevent this furniture from tipping over it must be permanently fixed to the wall. Fixing devices for the wall are not included since different wall materials require different types of fixing devices. Use fixing devices suitable for the walls in your home.

- Prevent children from climbing or hanging on the doors or shelves.
- If you are in any doubt as to how to install this product, consult a technically competent person.
- **CAUTION:** Always ensure the product is securely fitted before use.

**IMPORTANT RETAIN THIS INFORMATION FOR FUTURE REFERENCE: READ CAREFULLY**



# 01

1x AA

1x BB

2x CC

1x DD

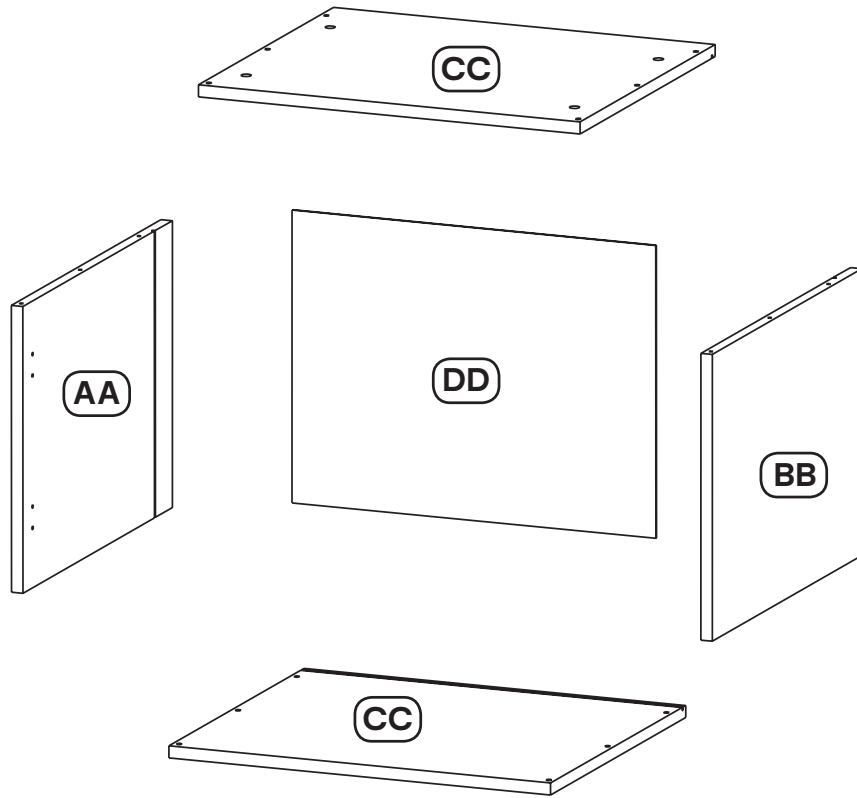

# 02

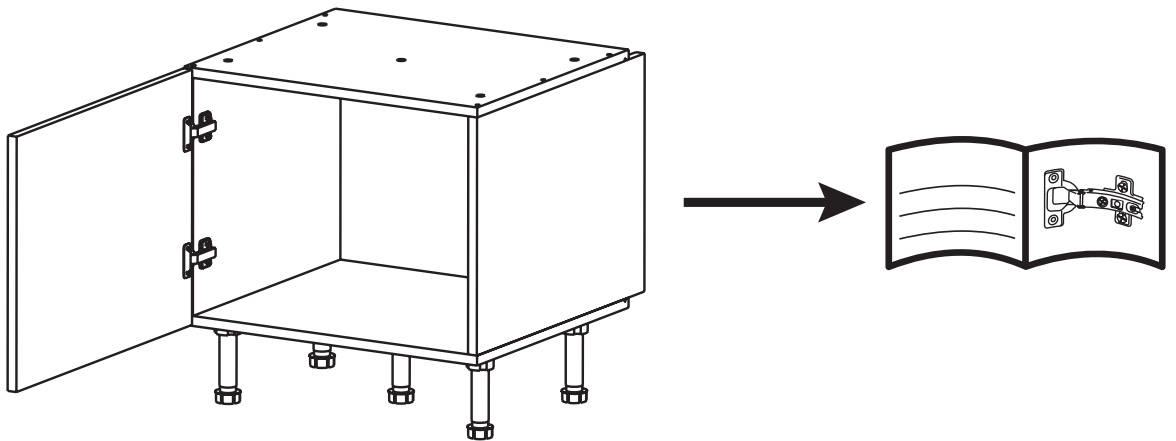

**FIT HINGES AFTER CABINET ASSEMBLY**



## 03

(x6) **K** 50mm

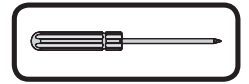
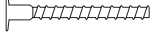

RUNNERS NOT SHOWN

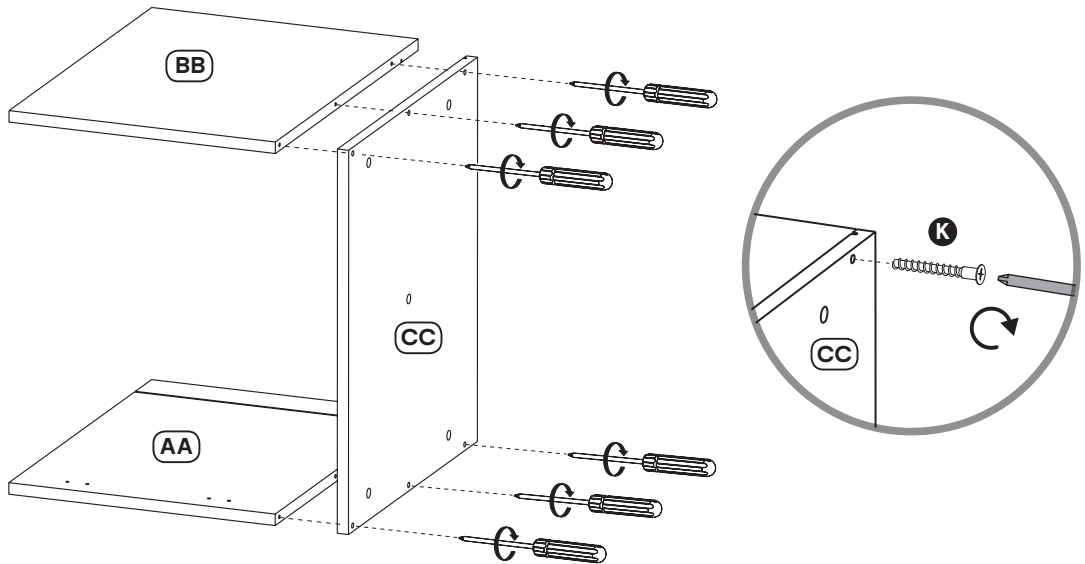

## 04

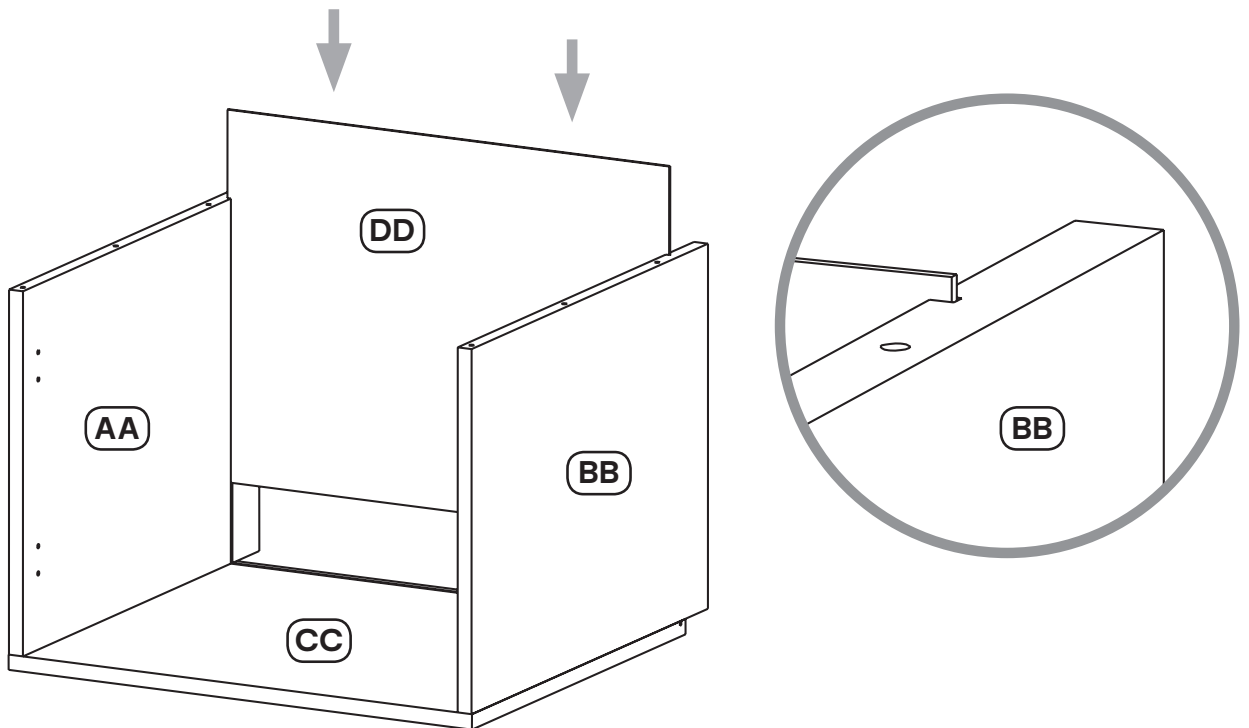



# Assembly

## 05

(x6) **K** 50mm

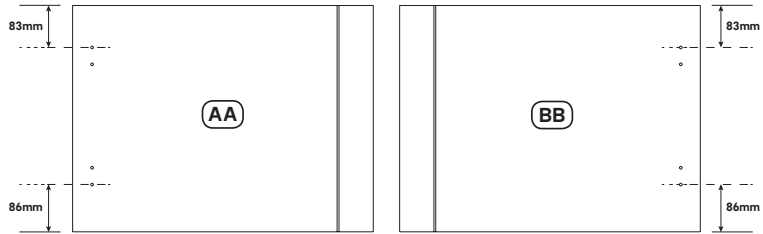
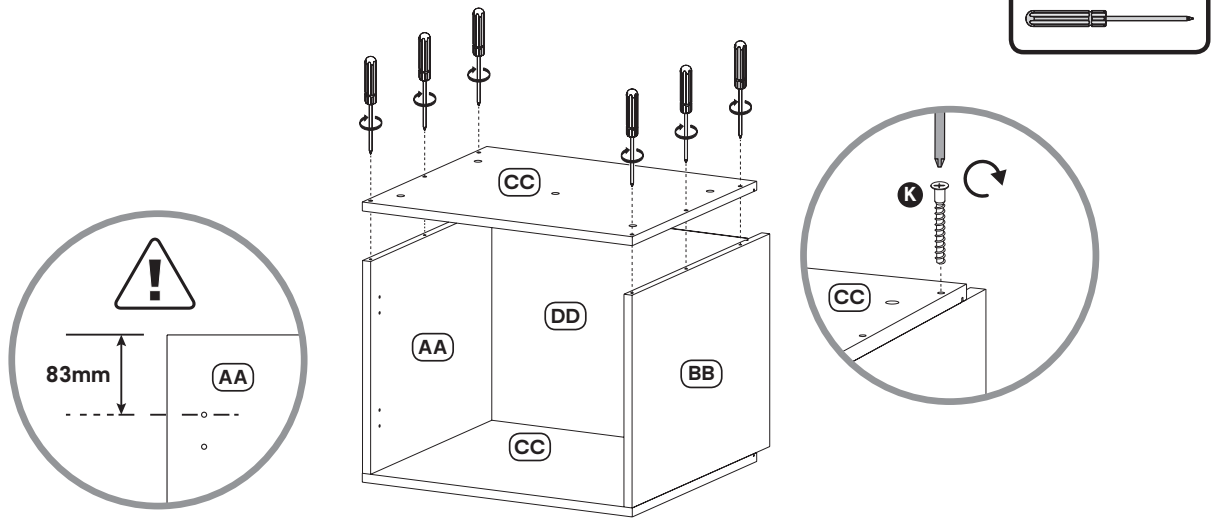

## 06

(x20) **D** 15mm

(x5) **W**

(x5) **X**

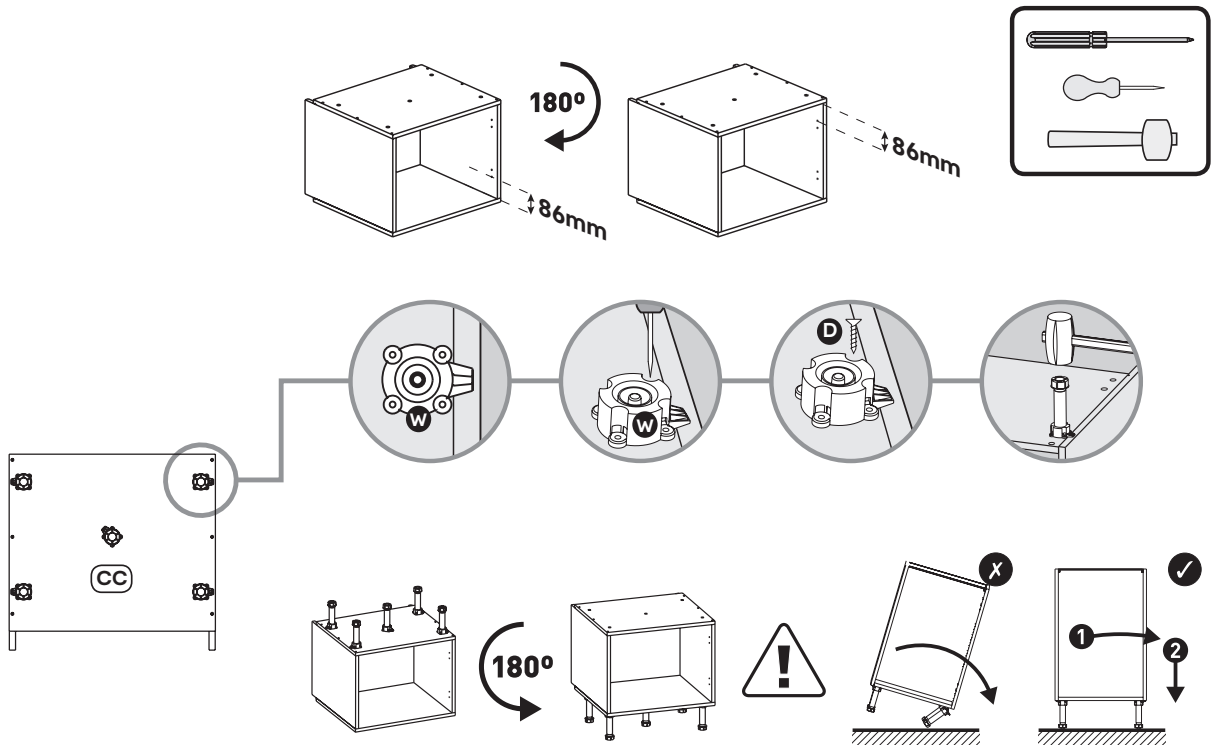



# Assembly

## 07

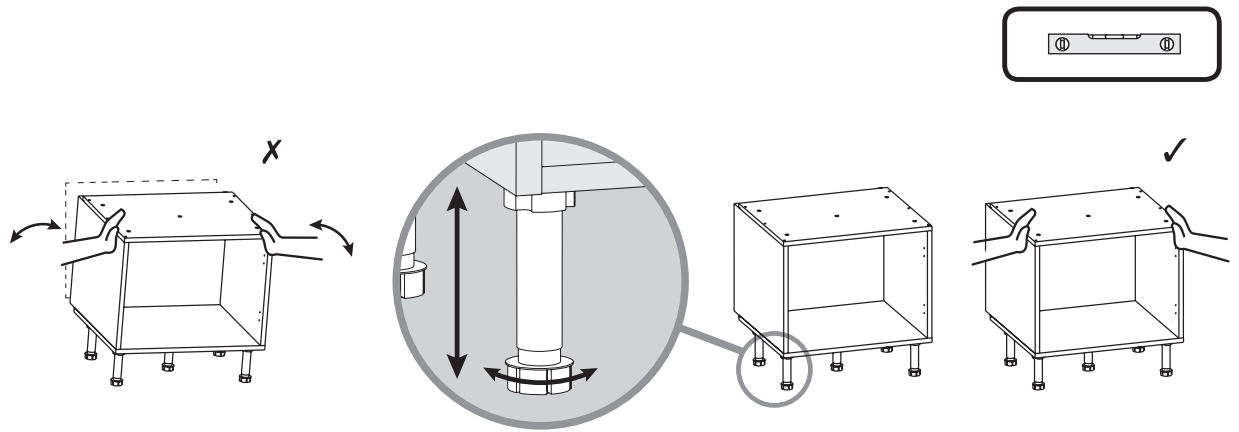

## 08

(x2) **F** 30mm

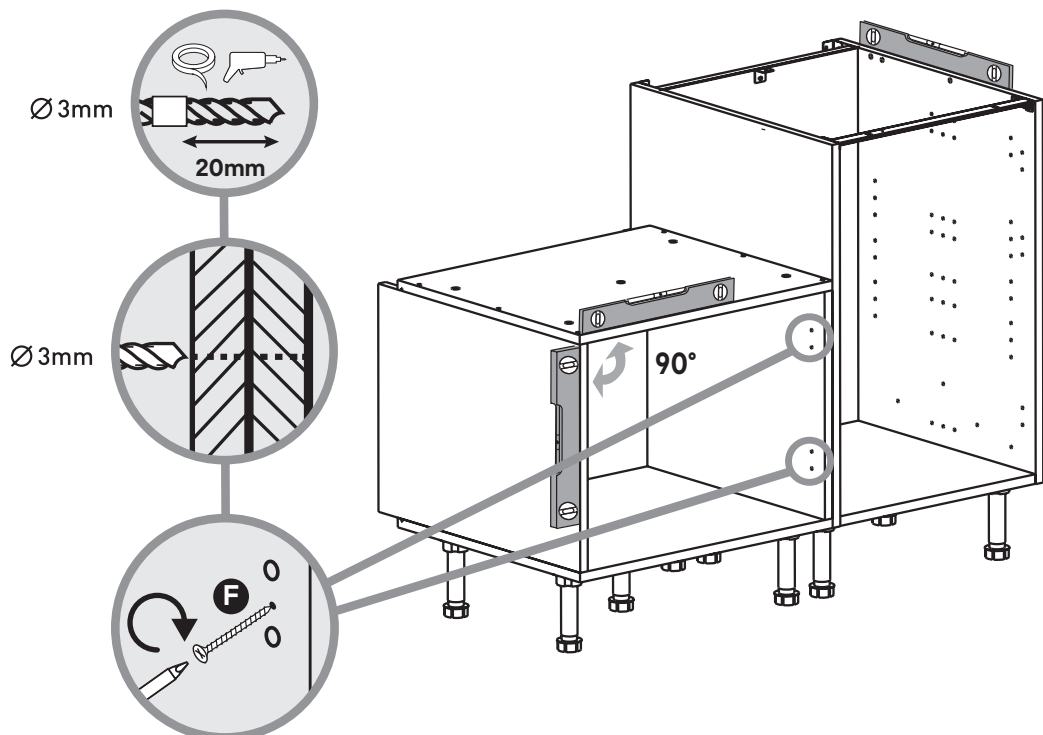
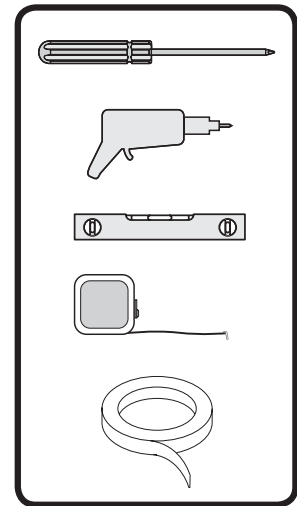





# Assembly

## 09

(x2) **D** 15mm 

(x2) **H** 

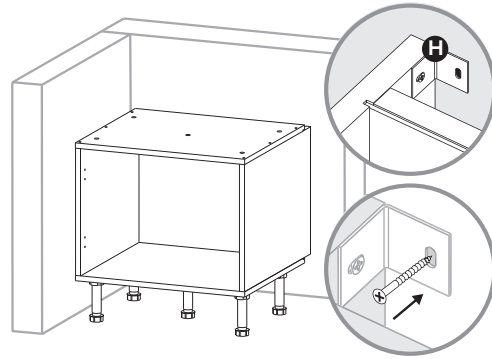
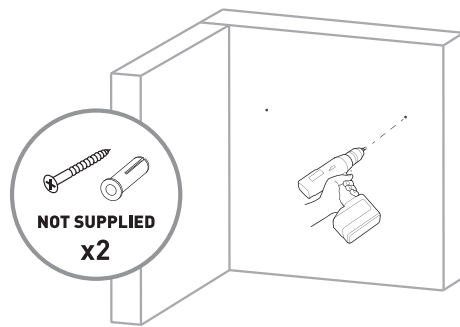
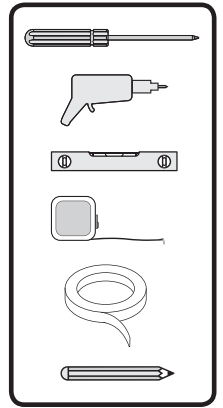
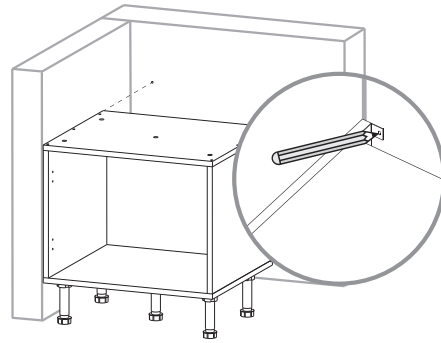
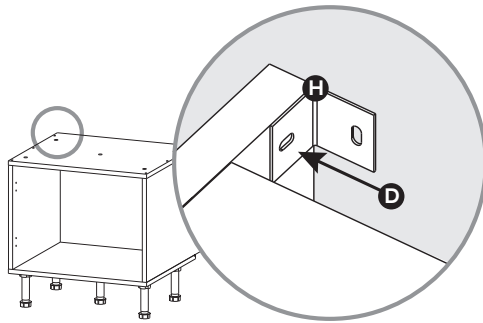

## 10

(x4) **D** 15mm 

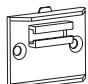
(x2) **Y** 

(x2) **Z** 

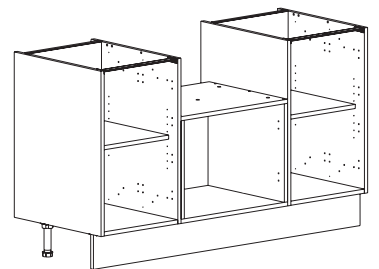
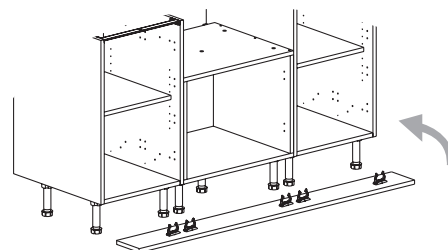
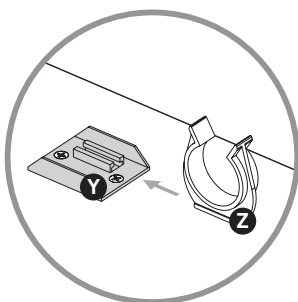
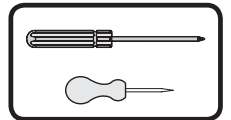
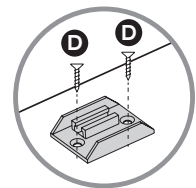
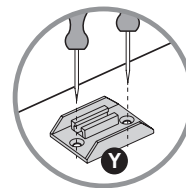
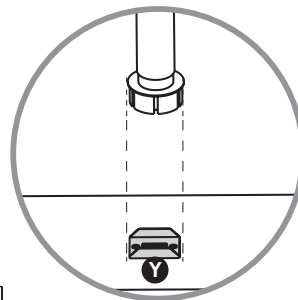
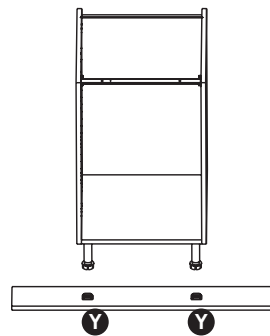



# 11

OPTIONAL ALUMINIUM LINER AVAILABLE

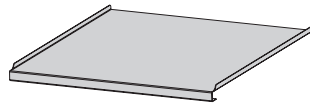

3663602632818

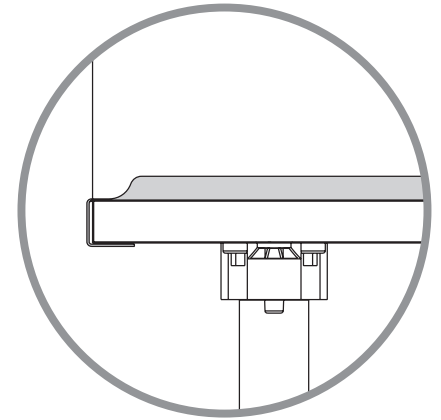
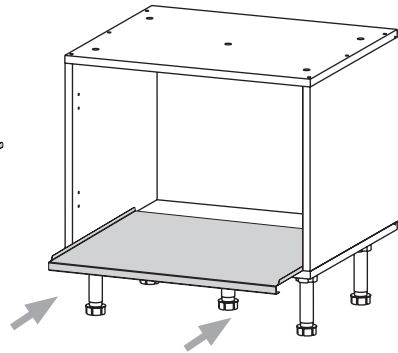

# Care & Maintenance

- Use warm soapy water and a soft damp cloth to clean the surface of the product. Wipe dry with a clean cloth.
- Avoid - Cleaning products, such as abrasive powders, glass wool or scouring pads, as well as cleaning products containing acetone, chlorine or solvents.
- Avoid - Steam cleaners
- Immediately remove any dirty marks as soon as they appear.
- From time to time, check that all fixings, apertures, runners, securing profiles, handles, attachment brackets, etc. are securely in place.



We take special care to select high quality materials and use manufacturing techniques that allow us to create products incorporating design and durability. The GoodHome Cabinet has a manufacturer's guarantee of 25 years against manufacturing defects, from the date of purchase (if bought in store) or date of delivery (if bought online), at no additional cost.

To make a claim under this guarantee, you must present your proof of purchase (such as a sales receipt, purchase invoice or other evidence admissible under applicable law), please keep your proof of purchase in a safe place. For this guarantee to apply, the product you purchased must be new, it will not apply to second hand or display products. Unless stated otherwise by applicable law, any replacement product issued under this guarantee will only be guaranteed until expiry of the original period guarantee period.

This guarantee covers product failures and malfunctions provided the product was used for the purpose for which it is intended and subject to installation, cleaning, care and maintenance in accordance with the information contained in these terms and conditions, in the user manual and standard practice, provided that standard practice does not conflict with the user manual.

This guarantee does not cover defects and damage caused by normal wear and tear or damage that could be the result of improper use, faulty installation or assembly, neglect, accident, misuse, or modification of the product. Unless stated otherwise by applicable law, this guarantee will not cover, in any case, ancillary costs (shipping, movement, costs of uninstalling and reinstalling, labour etc), or direct and indirect damage.

If the product is defective, we will, within a reasonable time, replace.

Rights under this guarantee are enforceable in the country in which you purchased this product. Guarantee related queries should be addressed to the store you purchased this product from.

The guarantee is in addition to and does not affect your statutory rights.

**UK Manufacturer:**

Kingfisher International Products Limited,  
3 Sheldon Square, London, W2 6PX,  
United Kingdom

**EU Manufacturer:**

Kingfisher International Products B.V.  
Rapenburgerstraat 175E  
1011 VM Amsterdam  
The Netherlands  
[www.kingfisher.com/products](http://www.kingfisher.com/products)

**EN** [www.diy.com](http://www.diy.com)  
[www.screwfix.com](http://www.screwfix.com)  
[www.screwfix.ie](http://www.screwfix.ie)

**To view instruction manuals online,  
visit [www.kingfisher.com/products](http://www.kingfisher.com/products)**

## Customer Service:

0333 014 3098 (General Enquiries)  
[bandqcustomerservices@b-and-q.co.uk](mailto:bandqcustomerservices@b-and-q.co.uk) (General Enquiries)

0333 014 3357 (Home Delivery only)  
[home.delivery@b-and-q.co.uk](mailto:home.delivery@b-and-q.co.uk) (Home Delivery only)

## Customer Service:

0333 011 2112  
[online@screwfix.com](mailto:online@screwfix.com)